

WN U-2

Fourth Revised Sheet No. M-1  
Cancels Third Revised Sheet No. M-1

**LEWIS RIVER TELEPHONE COMPANY, INC.**  
Washington

MAP OF EXCHANGE AREA

**APPROVED**

(N)

LA CENTER TELEPHONE COMPANY SERVICE AREA BOUNDARY DESCRIPTION

Beginning at the Southeast corner of the La Center exchange boundary, said corner being the East Quarter corner of Section 1, Town 4 North, Range 2 East of the WM, Clark County, Washington;

- thence, running West 4.5 miles to the center of Section 5 of said Town 4 North, Range 2 East of the WM;
- thence, running South 1.0 mile to the center of Section 8 of said Town 4 North, Range 2 East of the WM;
- thence, running West 0.5 miles to the East Quarter corner of Section 7 of said Town 4 North, Range 2 East of the WM;
- thence, running South 1.0 mile to the East Quarter corner of Section 18 of said Town 4 North, Range 2 East of the WM;
- thence, running West 0.5 miles to the center of Section 18 of said Town 4 North, Range 2 East of the WM;
- thence, running South a little more than 1 mile to the center of the East Fork of the Lewis River in the South one-half (S 1/2) of Section 19 of said Town 4 North, Range 2 East of the WM;
- thence, running in a generally Northwesterly direction along the center of said East Fork of the Lewis River approximately 2.5 miles to the South Section line of Section 11, Town 4 North, Range 1 East of the WM;
- thence, West 2.4 miles to the South Quarter corner of Section 9 of said Town 4 North, Range 1 East of the WM;
- thence, North 2.0 miles to the South Quarter corner of Section 33, Town 5 North, Range 1 East of the WM;
- thence, West 1.5 miles to the Southwest corner of Section 32 of said Town 5 North, Range 1 East of the WM and the center of the North Fork of the Lewis River;
- thence, Northerly along the center of the North Fork of the Lewis River approximately 0.5 miles to the West line of Section 32 of said Town 5 North, Range 1 East of the WM;
- thence, continuing North along the said West line of Section 32, 3.0 miles more or less to the West Quarter corner of Section 17 of said Town 5 North, Range 1 East of the WM;
- thence, East 4.5 miles to the Center of Section 13 of said Town 5 North, Range 1 East of the WM;
- thence, North 0.5 miles to the North Quarter corner of said Section 13, Town 5 North, Range 1 East of the WM;

(N)

ISSUED: November 23, 2005

EFFECTIVE: December 23, 2005

BY:

  
Paul E. Pederson

TITLE: Vice President

WN U-2

Original Sheet M-2

**LEWIS RIVER TELEPHONE COMPANY, INC.**  
Washington

**MAP OF EXCHANGE AREA**

**APPROVED**

**LA CENTER TELEPHONE COMPANY SERVICE AREA BOUNDARY DESCRIPTION**  
(Continued)

Beginning at the Southeast corner of the La Center exchange boundary, said corner being the East Quarter corner of Section 1, Town 4 North, Range 2 East of the WM, Clark County, Washington; (Continued)

thence, East along the North line of said Section 13, one-quarter (1/4) mile to the Southwest corner of the Southeast Quarter of the Southeast Quarter (SE 1/4, SE 1/4) of Section 12, Town 5 North, Range 1 East of the WM;

thence, North seven hundred forty four (744) feet to a point on the West line of said Southeast Quarter of the Southeast Quarter (SE 1/4, SE 1/4) of Section 12, Town 5 North, Range 1 East of the WM;

thence, East one-half (1/2) mile to a point on the West line of the Southeast Quarter of the Southwest Quarter (SE 1/4, SW 1/4) of Section 7, Town 5 North, Range 2 East of the WM;

thence, South seven hundred forty four (744) feet to the Southwest corner of the Southeast Quarter of the Southwest Quarter (SE 1/4, SW 1/4) of Section 7, Town 5 North, Range 2 East of the WM;

thence, East along the North lines of Sections 18, 17 and 16, 2 3/4 miles to the Northeast corner of said Section 16, Town 5 North, Range 2 East of the WM;

thence, North along the West line of Section 10 1.0 mile to the Northwest corner of said Section 10, Town 5 North, Range 2 East of the WM;

thence, East along the North line of said Section 10 1.0 mile to the Northeast corner of said Section 10, Town 5 North, Range 2 East of the WM;

thence, North along the West line of Section 2, Town 5 North, Range 2 East of the WM, Section 35 and 34, Town 6 North, Range 2 East of the WM approximately 2 1/4 miles to the Clark County/Cowitz County line at Lake Merwin;

thence, in a generally easterly direction along said County line and Lake Merwin approximately 2.0 miles to the East line of Section 24, Town 6 North, Range 2 East of the WM;

thence, South along the East line of Sections approximately 8 3/4 miles back to the point of beginning at the East Quarter corner of Section 1, Town 4 North, Range 2 East of the WM;

(N)  
|  
(N)

ISSUED: November 23, 2005



BY: \_\_\_\_\_  
Paul E. Pederson

EFFECTIVE: December 23, 2005

TITLE: Vice President

WN U-2

Original Sheet M-3

**LEWIS RIVER TELEPHONE COMPANY, INC.**  
Washington

MAP OF EXCHANGE AREA

**APPROVED**

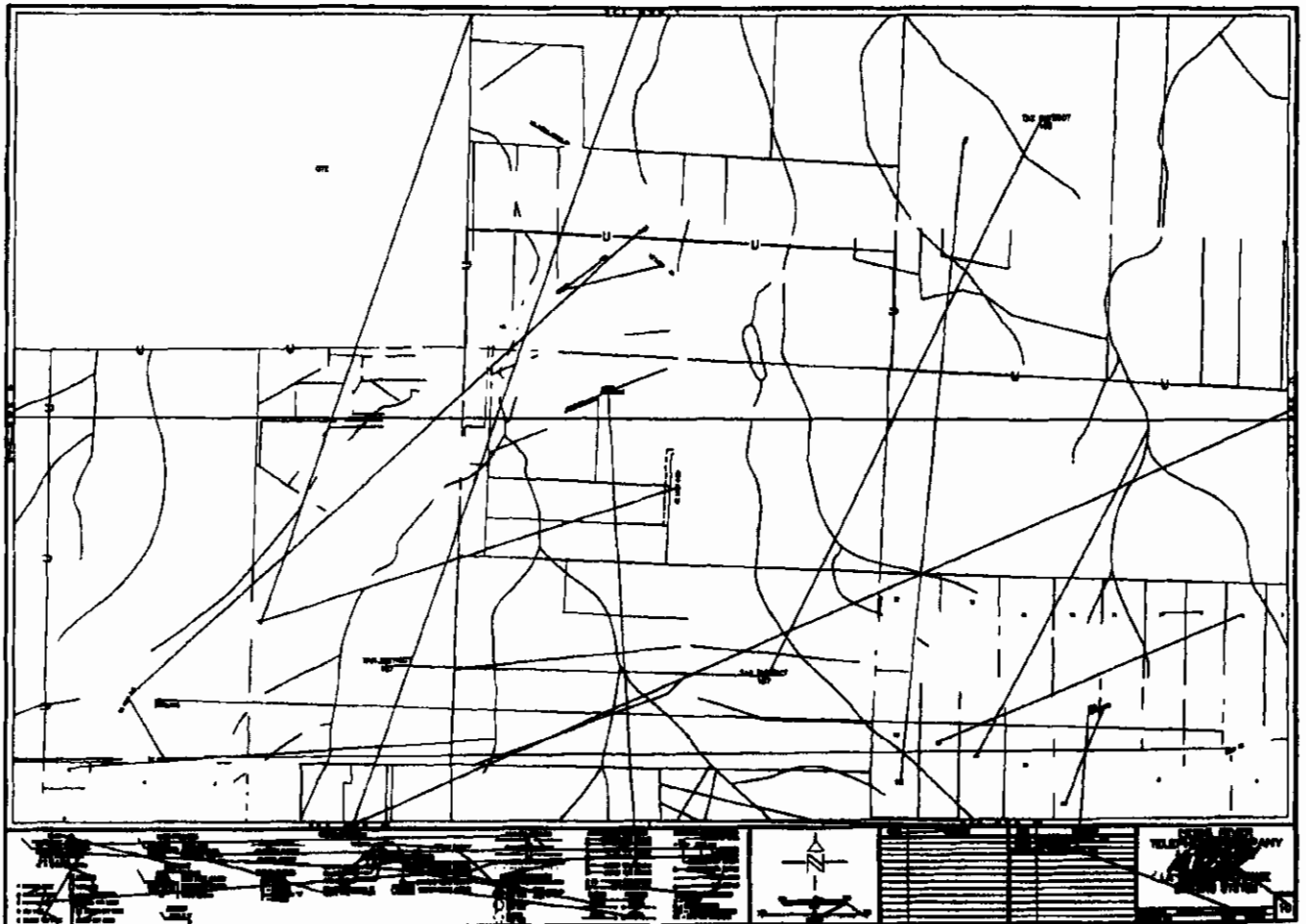

ISSUED: November 23, 2005

EFFECTIVE: December 23, 2005

BY: \_\_\_\_\_

Paul E. Pederson

TITLE: Vice President

WNU-2

Original Sheet M-4

**LEWIS RIVER TELEPHONE COMPANY, INC.**  
Washington

**MAP OF EXCHANGE AREA**

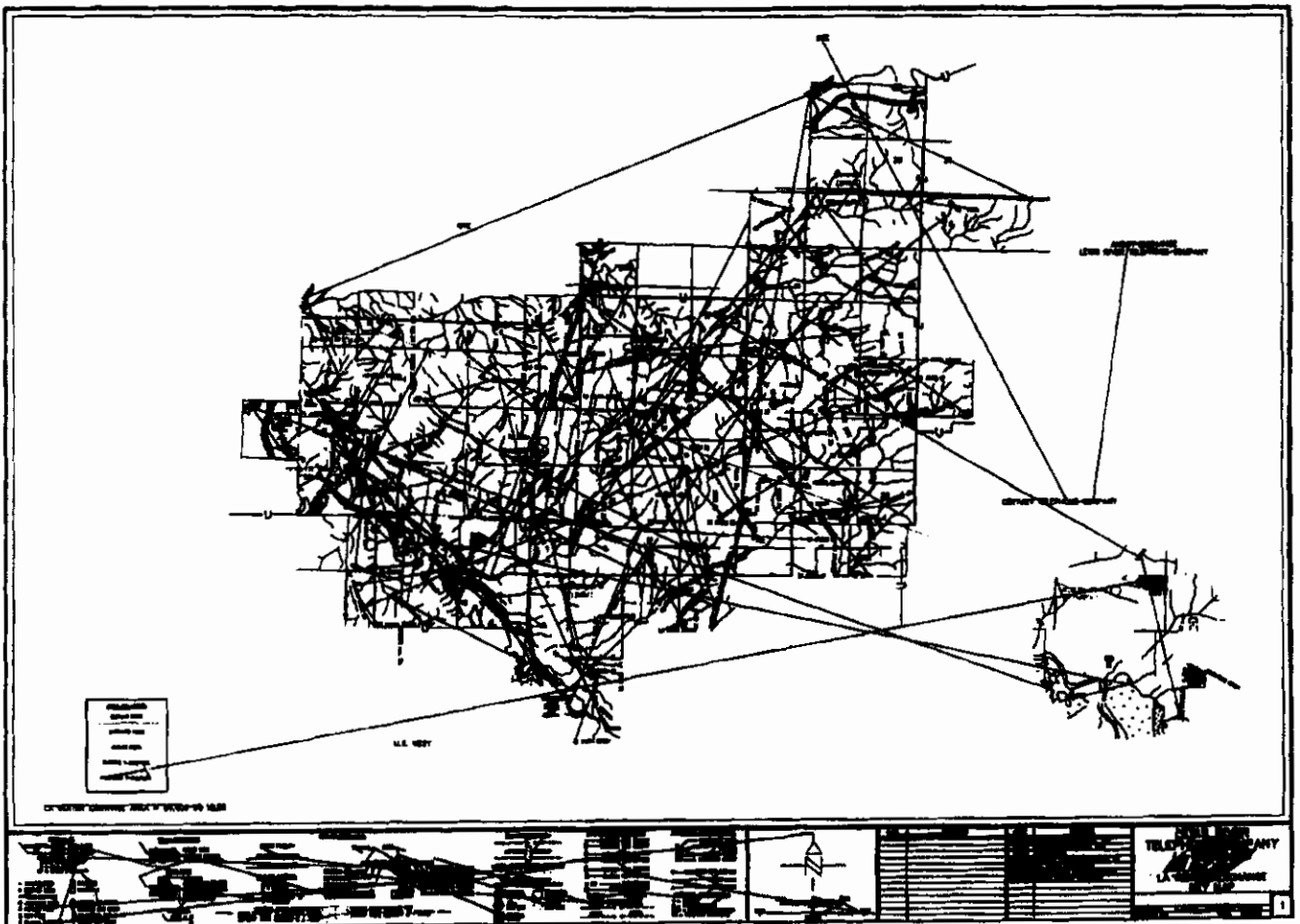

ISSUED: November 23, 2005

EFFECTIVE: December 23, 2005

BY: \_\_\_\_\_

Paul E. Pederson

TITLE: Vice President